

VERTILIFT 1 34X54 BIN #61

NOT FOR CONSTRUCTION

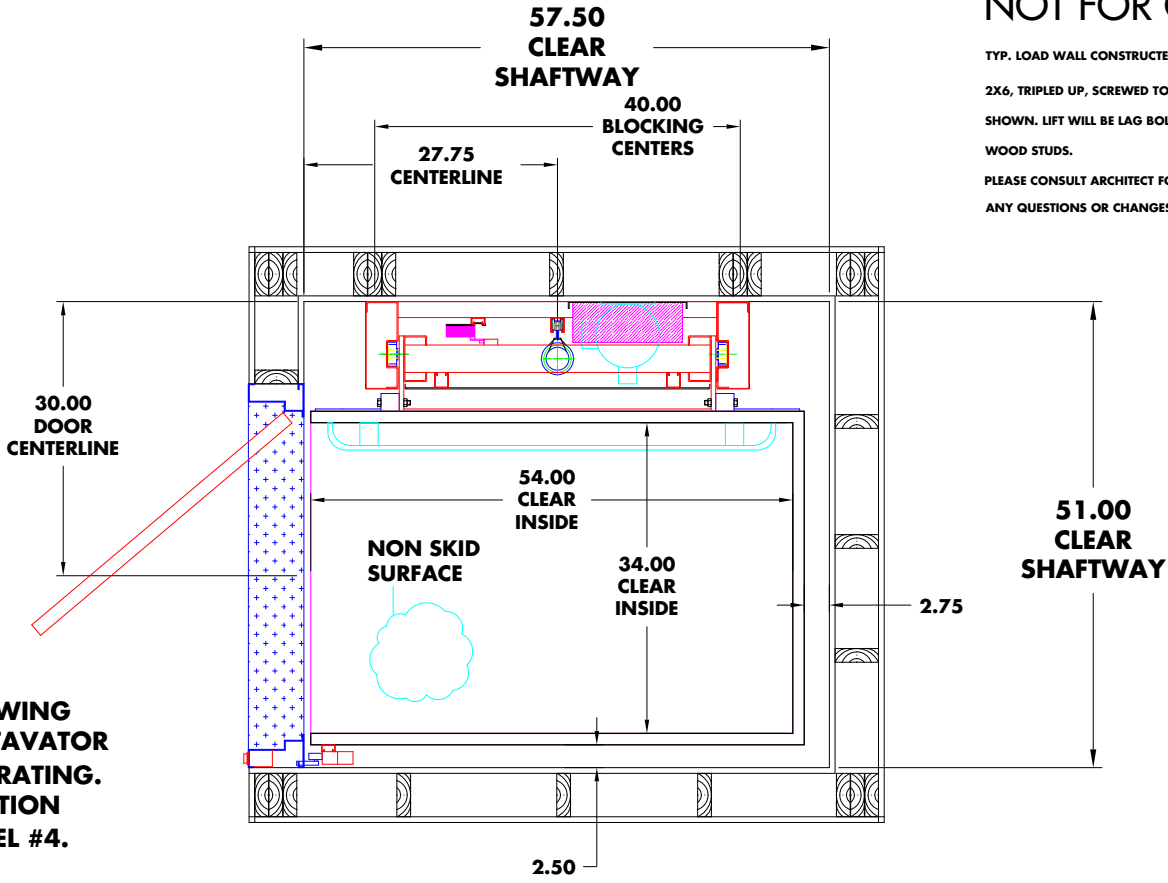

TYP. LOAD WALL CONSTRUCTED FROM WOOD
 2X6, TRIPLED UP, SCREWED TOGETHER ON LOCATIONS
 SHOWN. LIFT WILL BE LAG BOLTED INTO THE
 WOOD STUDS.
 PLEASE CONSULT ARCHITECT FOR
 ANY QUESTIONS OR CHANGES.

**3'-0" X 6'-8" SWING
 DOORS BY LIFTAVATOR
 1-1/2 HR FIRE RATING.
 HALL CALL STATION
 STAINLESS STEEL #4.**