

# MACHINE ROOM FREE RESIDENTIAL VLC2 BIN #64

TWO OPENING DRYWALL/STUD SHAFTWAY

1) THIS DIMENSION MUST BE MAINTAINED FROM TOP TO BOTTOM.

2) LIGHT AT TOP OF SHAFT TO HAVE MOTION SENSOR W/ ADJUSTABLE TIMER.

3) DOORS SUPPLIED TO BE EZ ENTRY "TUBE ANCHOR" STYLE DOORS W/ INTEGRATED HALL STATION, BARRIER FREE CLOSER AND HANDLE.

4) DOOR SWING CAN BE OPPOSITE HAND IF DESIRED, BUT REQUIRES ADDITIONAL TWO (2") OF CLEAR SHAFT. CONSULT FACTORY ENGINEER.

5) ENTRANCE DOORS SUPPLIED BY LIFTAVATOR AND INSTALLED BY THE GENERAL CONTRACTOR.

6) THE SUPPORT WALL MUST CARRY ALL REACTIONS AND TO BE BUILT BY THE GENERAL CONTRACTOR.

7) THE SHAFTWAY MUST BE BUILT TO DIMENSIONS SPECIFIED TO MEET A.N.S.I. A18.1B-2001, PART 2, VERTICAL PLATFORM LIFTS AND MEET ALL ELECTRICAL CODES AS PER THE N.E.C 2002.

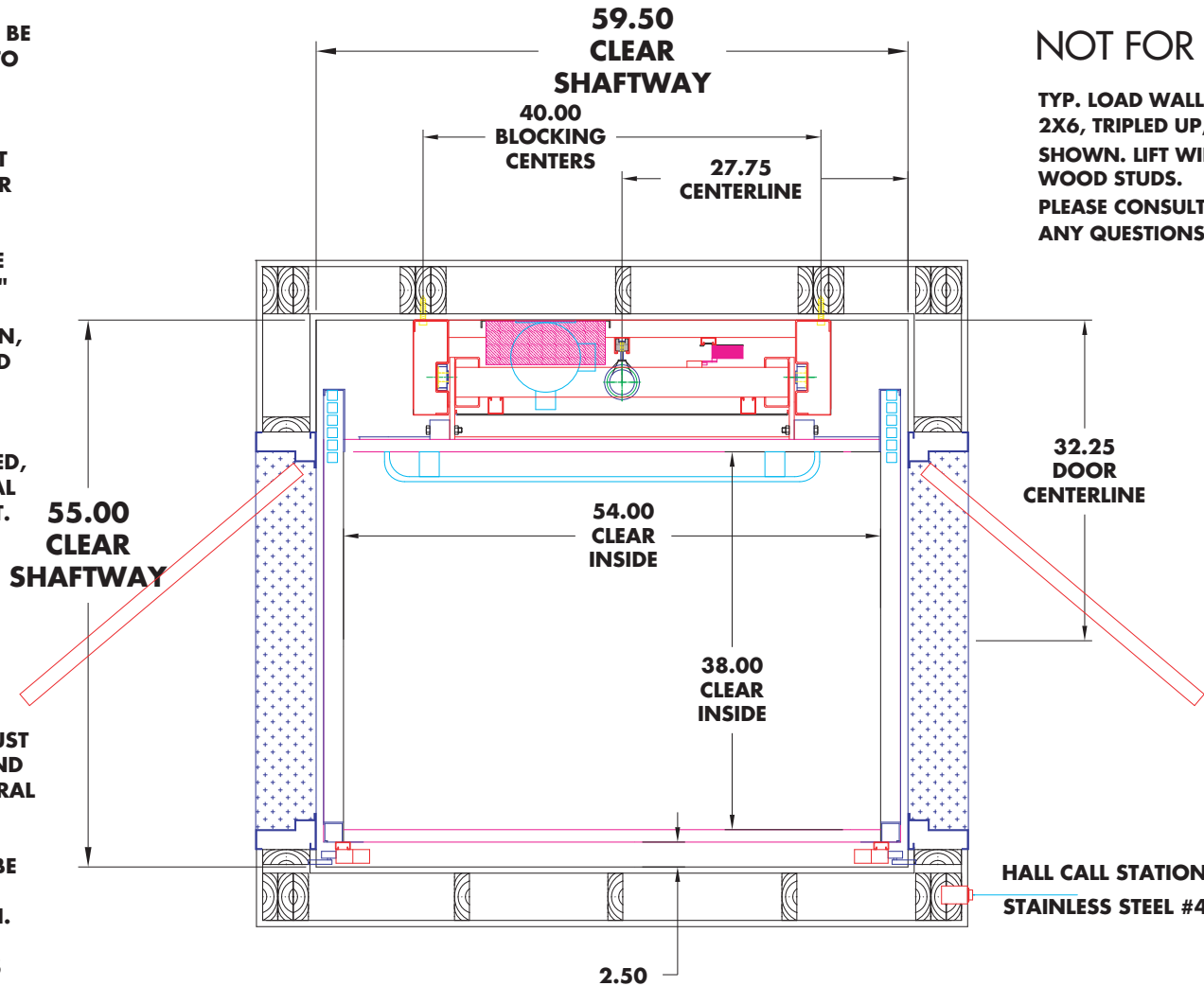

NOT FOR CONSTRUCTION

TYP. LOAD WALL CONSTRUCTED FROM WOOD 2X6, TRIPLED UP, SCREWED TOGETHER ON LOCATIONS SHOWN. LIFT WILL BE LAG BOLTED INTO THE WOOD STUDS.  
PLEASE CONSULT ARCHITECT FOR ANY QUESTIONS OR CHANGES.